

Lithium electric tile tiling machine

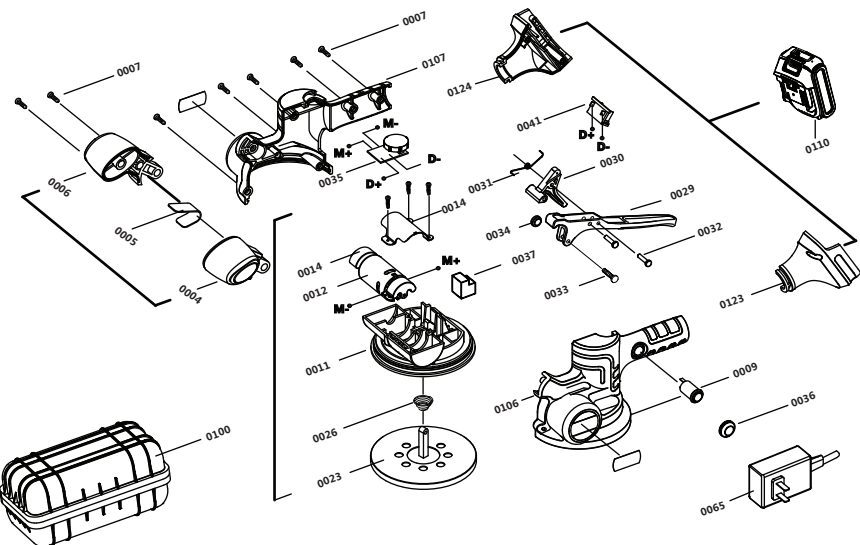

0106	Left casing	0030	Lock the trigger
0004	Left auxiliary handle	0031	Torsion spring
0005	leaf spring	0032	Semi hollow rivet
0006	Right auxiliary handle	0033	Cross screw
0007	Cross screw	0034	Lock nut
0107	Right casing	0035	Speed control board
0009	Self-reset switch	0036	silicon ha
0011	baseboard	0037	block rubber
0012	550 DC motor	0123	Left interface of battery holder
0013	15mm vibrating block	0041	Battery pin
0014	Motor pressing plate	0124	Right interface of battery holder
0023	Rubber sucker	0110	21Vlithium battery
0026	Tower spring	0065	Charger
0029	Sucker wrench	0100	Plastic box

LITHIUM ELEKTRISK VIBRATOR MED SUGEKOPP



21V MAX
2Ah
Lithium-ion
Intelligent Battery Technology

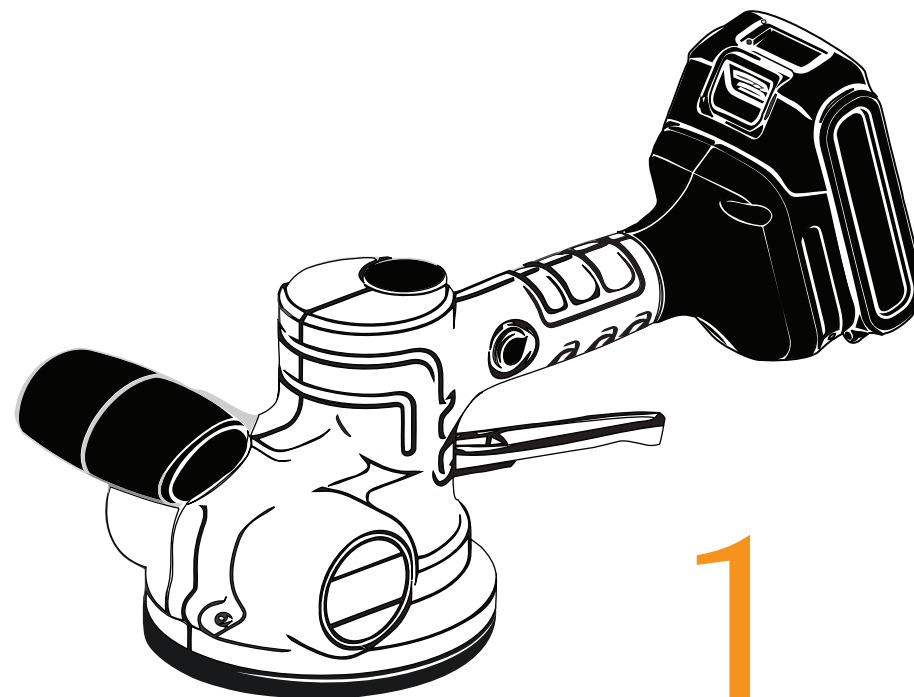

1

After Sale

1. Read the instructions and safety instructions before using the tools.
2. During the warranty period, the normal loss and artificial damage of consumable parts are not covered by the warranty.
3. During the warranty period, incorrect use or self-disassembly of tools and repairs are not covered by the warranty.
4. The user needs to send the tool back and pay the maintenance cost.
5. The buyer needs to pay the purchase cost and go to the repair place designated by the seller with the invoice.
6. This warranty certificate is applicable to the People's Republic of China.

This warranty certificate is valid with the seal of distribution unit, and invalid if it is overdue. Thank you!

Model		Signature and Seal of Distribution Unit
Distribution Unit		
User		
Address		
Invoice Date		

User Information Feedback Card:

Date	Damaged Parts	Remarks	Repairman

Maintenance Record:

2

Certificate:

Product Model _____
 Date of Production _____
 Product Number _____
 Examination Clerk _____

Product inspection

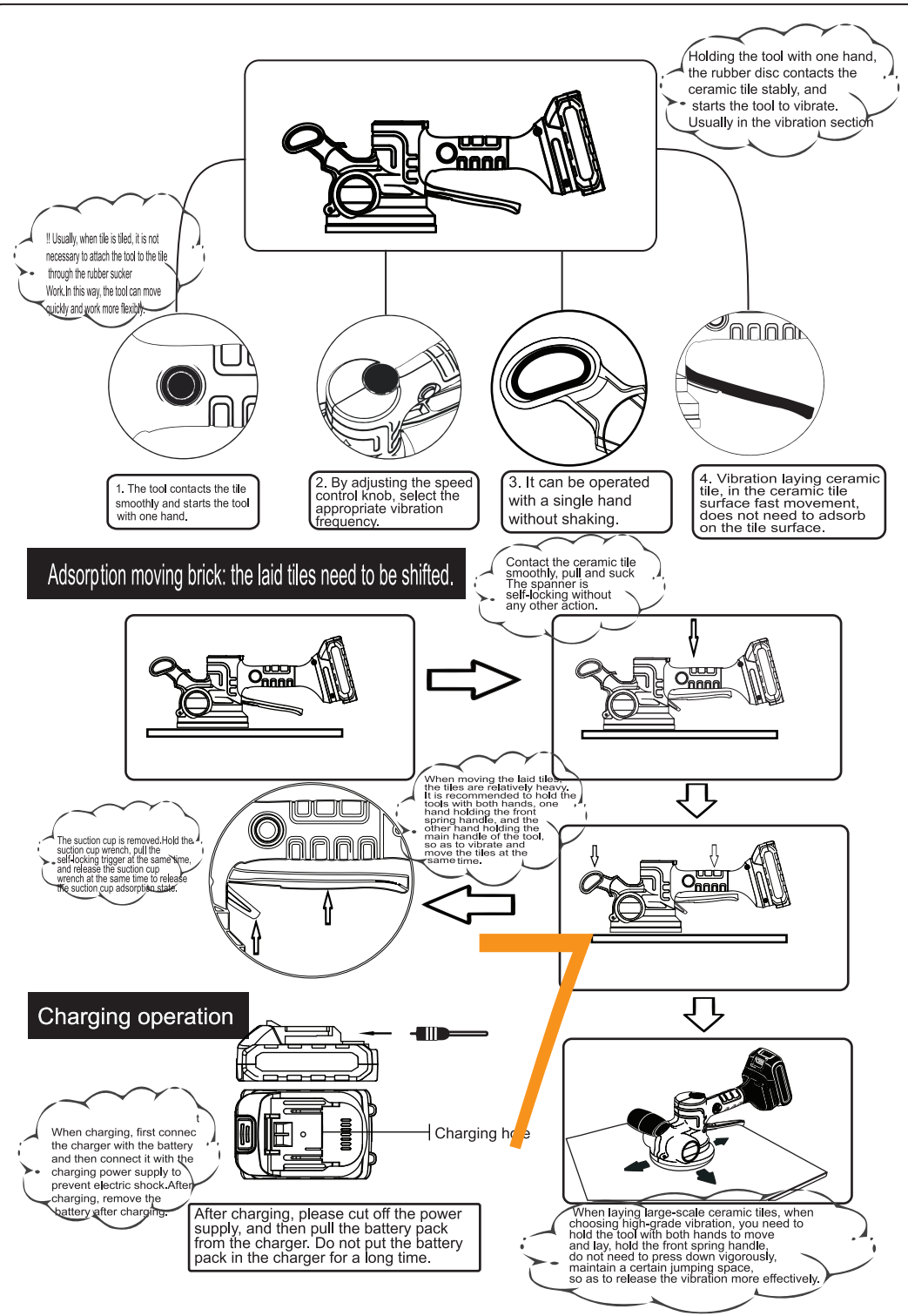

Instructions

Elastic auxiliary handle

1. Relieve hand fatigue injury caused by tool vibration.
2. Release the vibration of the tool and improve the penetrating power of the vibration.

Speed control knob

1. Freely adjust the vibration frequency from 1-6 levels and choose the appropriate paving intensity.

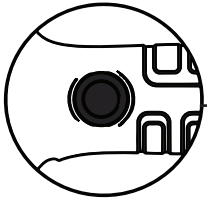
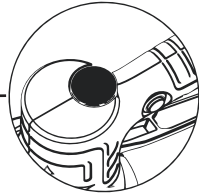

Start switch

1. Self-reset switch, press and hold to start

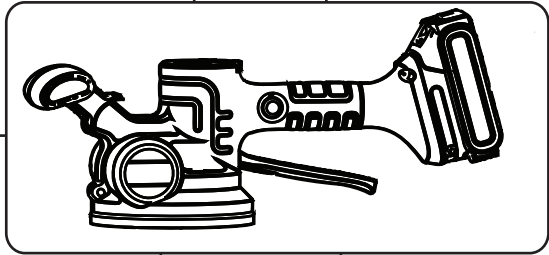

Self-locking/unlocking trigger

1. Automatically lock the suction cup wrench to prevent accidental loosening.
2. The operation is simple and fast.



Suction Cup Wrench

1. Lift the wrench and the suction cup will absorb the tiles.
2. Loosen the wrench to release the tiles.

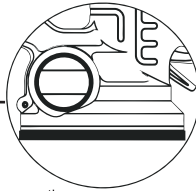

Rubber suction cup

1. Absorb the tiles and move the tiles.
2. Adsorb the tool and hang the tool on the wall

Press the start switch to start the tool.

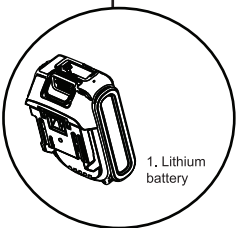
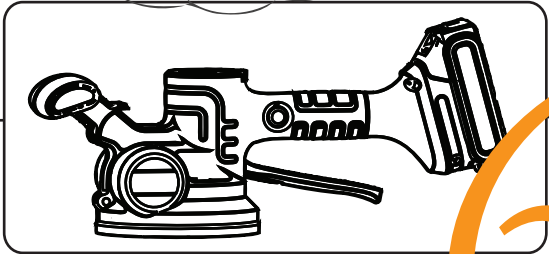

1. Lithium battery

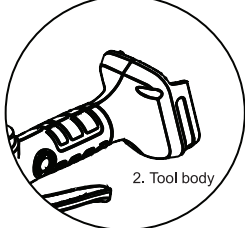

2. Tool body

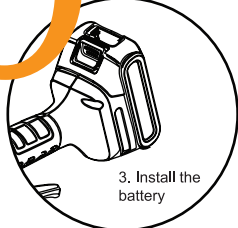





3. Install the battery

Main Application:

1	Laying tiles	Tiles within 1200mm
2	Tile floor	Normal floor and compound floor
3	Laying the carpet	Regular use of composite thin carpet



Security Information:

			
After using tools, please do not wash the tools with water, it will cause the battery short-circuit, burn or explode.	Avoid using the tools in the rainy days.	Tools can not use in the high temperature environment.	Disused tools can not throw away, please recycle properly.

Product description:

1.Spring handle

2.Speed control knob

3.Start switch

4.Lithium battery

5.Rubber suction cup

6.Unlock the trigger

7.Suction Cup Wrench

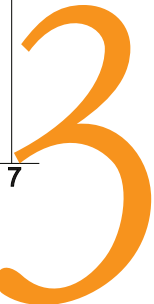
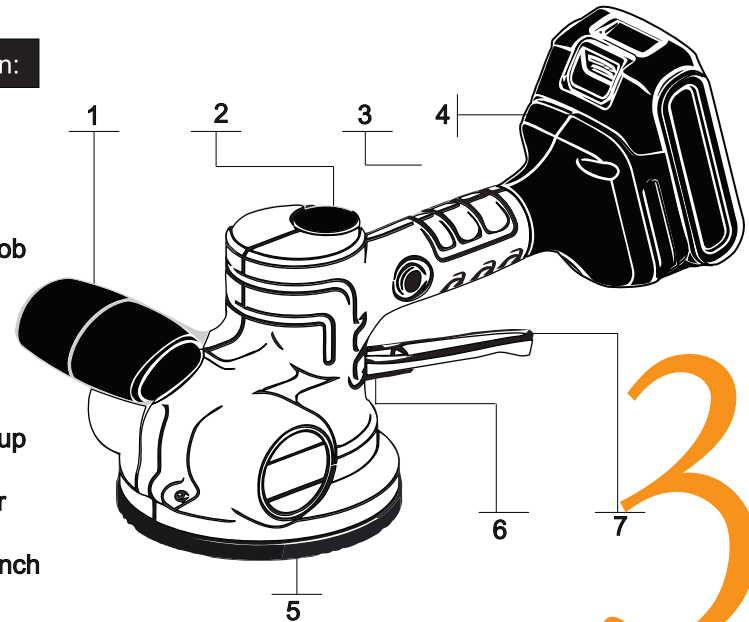

Safety instructions:

Warning! Read the instructions. Failure to follow the instructions listed below will cause electric shock, fire or other serious injuries.

Work place: Do not use the battery charger in an explosive environment, such as an environment with flammable liquid gas or dust.

Electrical Safety: The charger plug matches the socket, and the plug must not be modified in any way; the battery charger must not be exposed to rain or snow or humid environments; let the battery charger

Keep away from hot oil moving parts.

The use and precautions of the charger: Store idle battery chargers out of the reach of children, and do not let people who are unfamiliar with battery chargers or who do not understand these instructions use them.

For the sake of safety, it is not recommended to use the charger without supervision, disabled people with low intelligence, inexperience or independent operation ability (including children). Please guard the children,

Prevent it from using this charger as a toy;

The power supply voltage used during charging must be consistent with the voltage specification marked on the charger to ensure that the charger is in a ventilated and non-flammable place. When charging, the charger will become slightly warmer. This is normal phenomenon. Avoid unattended, so as not to cause other dangers.

After charging complete, please cut off the power supply and unplug the battery pack from the charger. Do not leave the battery pack in the charger for a long time. When maintaining or cleaning the charger, be sure to unplug it from the socket. In this way, the risk of electric shock can be reduced. Only use a soft dry cloth to wipe the battery and charger.

Do not use damp cloth with diluent, gasoline or other volatile solvents for cleaning.

This charger can only be charged by this machine, if charging other machines, it may cause accidents.

Please do not open the battery or the charger. Please protect the battery charger from impact. The storage place of the battery charger must be moisture-proof and explosion-proof.

Do not use the charger for other purposes.

Make sure there is no abnormality in the charger slot, and avoid dirt or moisture. Do not dispose the battery charger in general household trash.

Do not charge damaged battery packs.

Do not charge non-rechargeable batteries, otherwise it may cause overheating reaction or even burst.

In order to charge the battery pack normally, do not charge it in an environment below 0 degrees Celsius or above 45 degrees Celsius, otherwise it will damage the battery pack or fail to charge.

Do not use the charger with a damaged power cord or plug. If the power cord or plug is damaged, it must be replaced by a professional from the manufacturer's maintenance department or similar department. Please use the original power cord to replace it.

To prevent electric shock, do not touch uninsulated output link parts or uninsulated battery terminals.

Charging operation:

Plug the charger into the AC power pack. After the battery is fully charged, unplug the charger plug from the AC socket and pull the battery pack out of the charger.

The operating temperature range of battery charger is 0 to 50 °C.

Attention! Please make sure that the AC voltage parameters meet the voltage requirements on the charger's name plate! 1. The battery pack is only partially charged at the time of delivery. Before the formal operation, please fully charge the battery pack in the room

Charge the battery at 0 to 50 degrees Celsius.

2. If the service time of battery pack is significantly shortened after each charging, please replace it with a new one. The battery pack can be charged at any time without shortening the service life of the battery. If the charging process is interrupted suddenly, the battery pack will not be damaged.

3. A new battery pack or a battery pack that has not been used for a long time needs to be charged and discharged for 3 to 4 times to give full play to the battery's maximum efficiency.

4. In a high temperature environment or after a long time of use, the machine may get hot. Please do not charge the battery immediately. Do not recharge the battery pack until it is cool, otherwise the service life of the battery pack will be shortened, or the battery pack cannot be charged due to overheating.





5. When charging more than two battery packs continuously, make the charger cool down before charging, otherwise it may not be able to charge normally.

Charger indicator

The charger can detect some kind of fault caused by the battery pack through the red indicator light (hereinafter referred to as red light) and

Green indicator light (hereinafter referred to as green light). In case of failure, insert the battery pack into the charger again. If the fault still exists, use another battery pack. If the new battery pack can be charged normally, the original battery pack may be damaged. If the new battery pack still produces the same fault indicator, the charger may be damaged and needs to be inspected and repaired.

The relationship between indicator state and charging state is shown in the

State of charge	Icon	Indicator icon (green light)	Indicator icon (red light)	Indicator status description
description Plug in the AC plug		✓		
The battery pack is charging			✓	
Battery pack charging completed		✓		
Abnormal battery pack				Flash
Battery protection status		✓		

Product Specifications

Technical Parameters	
Vibration frequency	0 - 7500rpm
battery capacity	2Ah - Li-ion
product weight	1.5KG
Product Size	380*130*136
Suction cup diameter	130mm
Suction of the sucker	50KG

Speed control table	
0gear	0000rpm
1gear	1500rpm
2gear	3000rpm
3gear	4500rpm
4gear	6000rpm
5gear	7500rpm